

TX61 LED

Innovative zone 2 LED luminaire



Description

TX61's low building profile along with its slim and elegant design makes it the best solution for Zone 2/22 areas. The robust TX61 watertight LED luminaire is part of a complete range of lighting equipment designed for use in hazardous areas. TX61 is designed for Zone 2 and 22 according to EN 60079. The luminaire is ideally suited for onshore and offshore oil and gas, marine environment and other potentially explosive industrial environments.

Long system lifetime and excellent heat management

The design housing has an optimal heat management. We can achieve a long system lifetime due to our Aluminium heat conductance ability. The TX61 is constructed to meet its challenges and is designed for a rated lifetime of 100,000 hours at Ta45°C ambient temperature.

Water ingress protection

The combination of LED technology, heat sink and limited gasket length eliminates system breathing when switching off the luminaire. This reduces exposure for water ingress and subsequent earth faults. The design of the body and diffuser ensures the ingress rating of IP66 and IP67.

Corrosion free

The body is made of Seawater resistant aluminium. Brackets and accessories are made of stainless steel (316L) to avoid corrosion. The TX61 minimise the temperature difference between the outside and the inside of the luminaries.

Health and safety

A working environment with high visual comfort and performance is one of the most important factors for the personnel to be safe and productive. The TX61 fulfils the requirements for good lighting practice and safe working environment (EN12464-1/2), and meets international standards for glare.

Technical specifications

Housing

Seawater resistant, anodized aluminium housing with external earthing

Lightsource/Optic

Designed in two length with 2200 or 4500 lumen output from the fixture, Led's are covered by softopalic polycarbonate diffuser.

Electrical specification

Flexible wiring heat resistant up to 105°C. Versions with through wiring are available. High quality zone 2 driver 220V-240V 50/60Hz

Mounting

Mounted to the ceiling or cable trays by screws. Different screwed mounting brackets, shock mounts or triangles are available.

Application

For all zone 2 areas in onshore and offshore demanding applications.

Design

According to rules of maritime classification societies, additional according to VDE and IEC/EN

Ambient temperature (Ta)

Operation from -25°C up to +50°C

Finish

Grey anodized

Connection

Connection box with 2 certified cable entry M25 polyamide D10-17mm and blind plugs M25 polyamide. Terminals for 6 mm² core diameter

Remarks

ES = Earthing sheet inside Junction box
EO = Exernal Potential Conductor outside
ET = Earthing tag inside Junction box





Illustrations

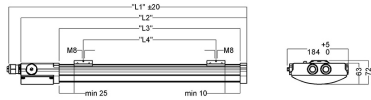

Type	L1	L2	L3	L4
TX614...	718	892	1066	1240
TX617...	1200	1353	1518	1670

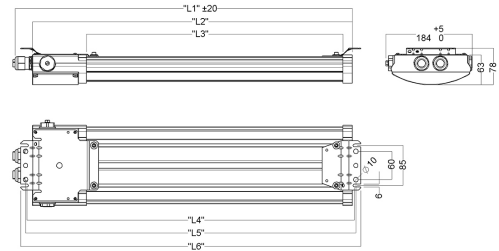

Type	L1	L2	L3	L4	L5	L6
TX614...	718	892	1066	1240	1414	1588
TX617...	1200	1353	1518	1670	1823	1976

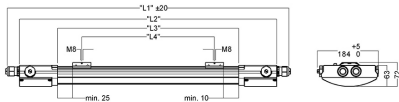

Type	L1	L2	L3	L4
TX614...	849	1011	1173	1335
TX617...	1421	1548	1675	1802

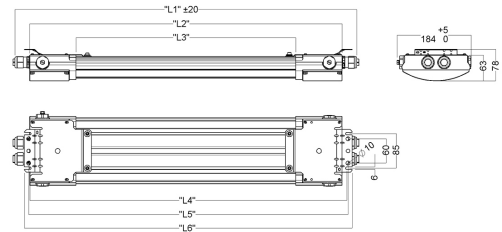

Type	L1	L2	L3	L4	L5	L6
TX614...	849	1011	1173	1335	1497	1659
TX617...	1420	1548	1675	1802	1929	2057

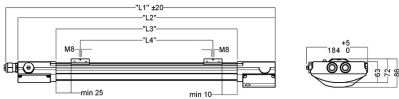

Type	L1	L2	L3	L4
TX614...	813	976	1139	1302
TX617...	1385	1548	1711	1874

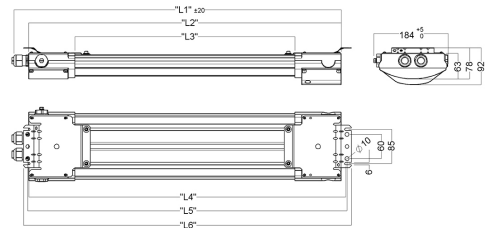

Type	L1	L2	L3	L4	L5	L6
TX614...	813	976	1139	1302	1465	1628
TX617...	1385	1548	1711	1874	2037	2200

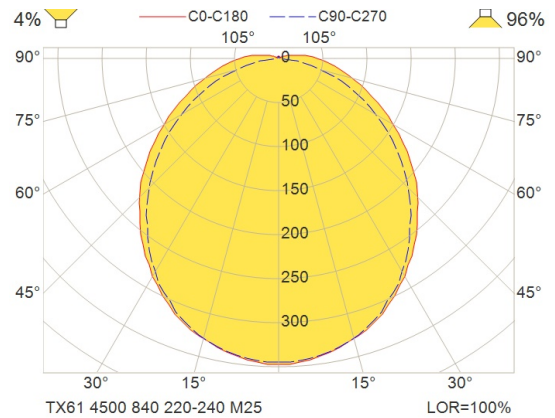
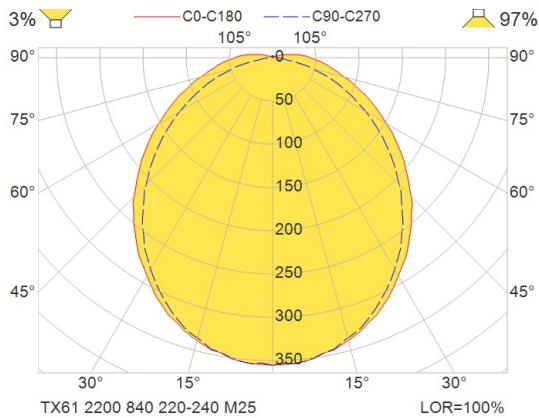

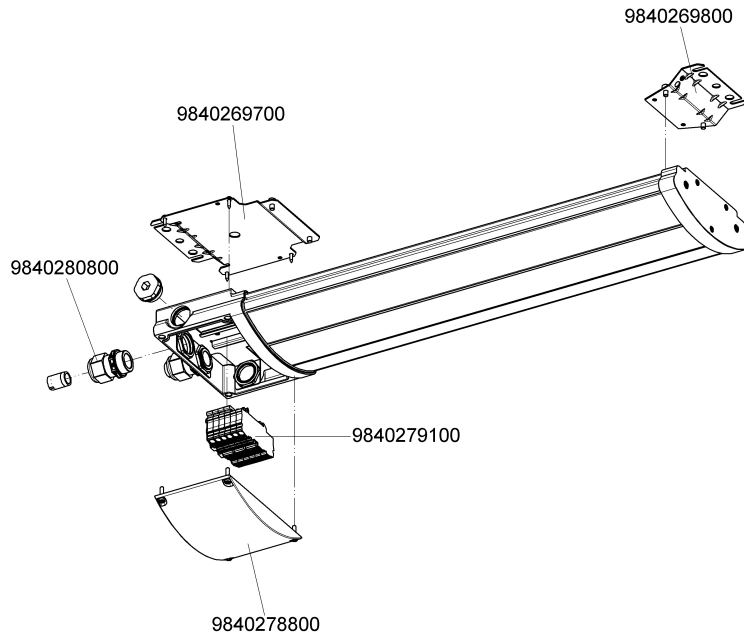



Images

