

# 1448

Multipurpose luminaire surface



## Description

High quality luminaire for marine use. The luminaire has easy access to terminal block and other electric components. The luminaire housing is made of zinc coated steel or stainless steel. Housing of zinc coated steel not suitable for marine outdoor installation. There is a white painted steel plate covering the electrical components. The cover is made of impact-proof polycarbonate (PC). Emergency versions are available.

## Technical specifications

### Application

For workshops, engine rooms, stores, holds and passage ways, etc.

### Design

According to rules of maritime classification societies, additional VDE and IEC/EN.

### Finish

Powder coated white RAL9016 and enamelled up to 70-80 µm thickness

### Cable entry

To be ordered separately: e.g. M20, M24 x 1.5 MGG/MGCG.

### Termination

Terminal 3-pole/6mm<sup>2</sup>

### Housing

Aluzink, Zinc coated steel, or stainless steel (AISI 316L), powder coated white RAL 9016.

### Lightsource/Optic

LED or 2 lamps of T5. Lamp base G5. 8W/lamp. Clear polycarbonate diffuser.

### Electrical specification

With magnetic ballast, low or high power factor, as standard; electronic ballast available. Flexible wiring heat resistant up to 105°C.

### Mounting

To be mounted with 2 holes Ø 13 mm; preinstalled threaded bushing or fixed end brackets.

# Illustrations

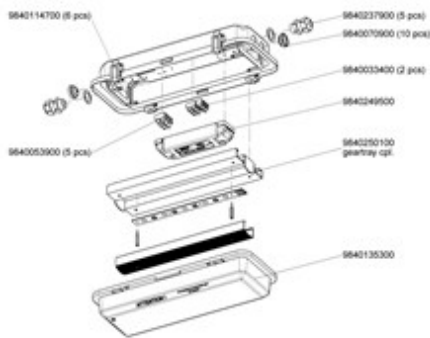
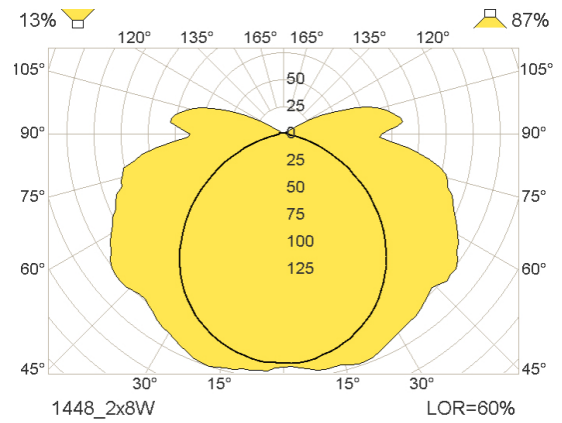
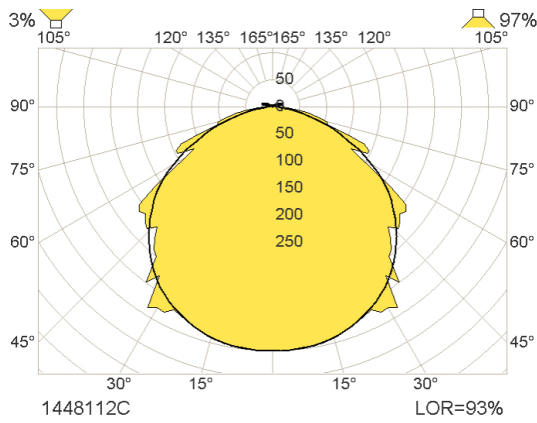
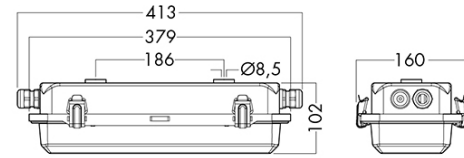
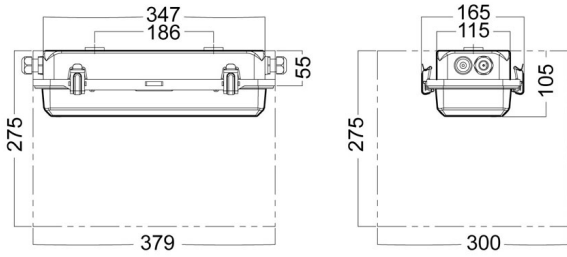



### Spare Parts

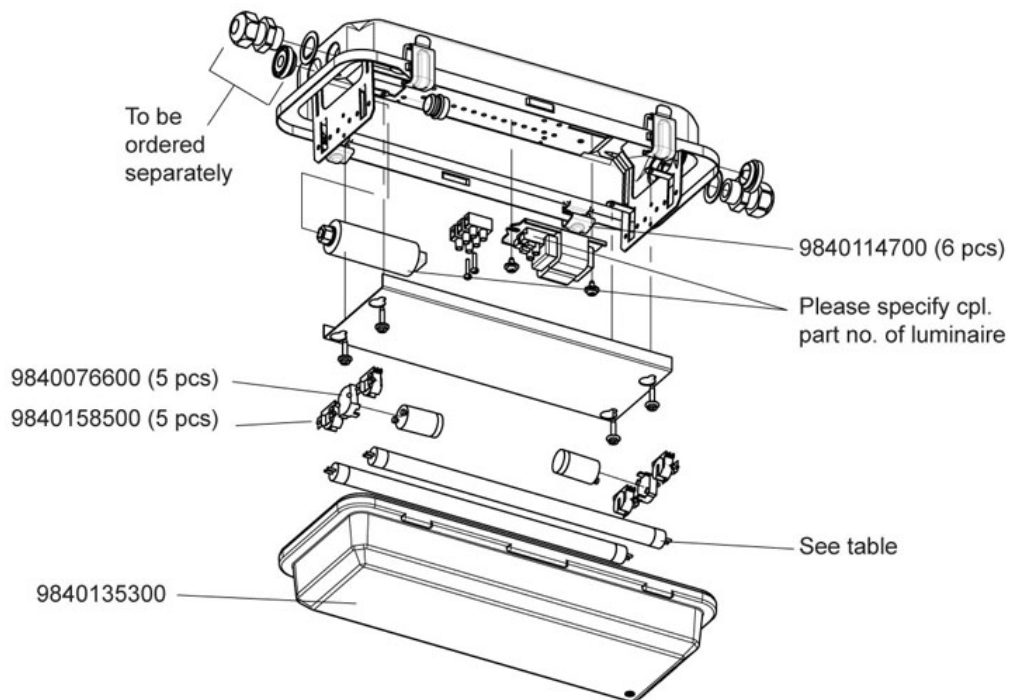

### Images

