

CL38 HMI Searchlight



Description

The product family CL38 is our most powerful searchlight that is based on HMI light technology. It shares all features with the CL35 but with 30% more light power.

The CL38 is available in standing or in hanging version and with optional integrated IR thermal camera.

In combination with the special designed parabolic reflector this searchlight gives an extraordinary useful light performance that is ensured throughout the life of the bulb. The high color temperature in combination with the high color spectra (CRI) gives an impression of clear daylight with good contrasts of objects. It is very energy efficient providing a massive 130000 Lumen at only 1600W.

The unlimited movement functionality offers limitless operational freedom and superior sea area coverage. In combination with the intelligent control system, it is possible to control many searchlights and control panels in network. The system is also open to be integrated with other systems onboard.

The proven design and mechanical concept is very solid and all mechanical structure is embedded inside the housing. This reduces problems coming from external influences like ice or corrosion. The housing itself is made in acid proof stainless steel and withstand the extreme tough marine environment.

The concept is developed over 20 years and is highly appreciated among mariners all over the world.

- A proven robust and functional design
- Marine resistant materials of highest class
- Maintenance free, monitored electrical motors.
- Unlimited maneuverability for superior sea area coverage
- Superior operator control system with system feedback
- Language selections in display
- Energy Efficient
- Extremely powerful HMI
- Massive Lumen output
- 1 lux at 6400 m
- 130 000 Lm
- Wide focus range



- FiFi regulation compliance
- Standing or hanging version available
- Optional with Integrated IR thermal camera
- Ready for integration

Technical specifications

Technology

Dual Head Searchlight with endless rotation in both pan und tilt. HMI light source with hot restrike and adjustable beam focus. Remote control and ready for integration.

Input power

100-240VAC, 50/60Hz Maximum Power Draw - 2000W

Body material and colour

Acidproof Stainless Steel. Powder coated in White RAL9016

Light output

130000 Lumen CRI >90 6000K

Beam angle

Adjustable 3-20°

Candela (measured)

38,1 MCd

Range with 1 lux at target

6100m

Weight

80kg

Dimensions

67×113×75cm

Others

For a working searchlight system also choose: -Ebox, for AC. -Cable lengths of mandatory cables, Power-/signal cables. -Operator panel and other accessories



Illustrations

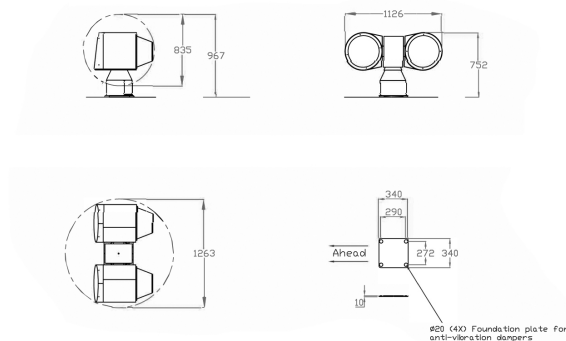

Build your searchlight system / CL25/35/38

Required Items to build a working searchlight system



Searchlight model

- Standing or Upside/Down
- IR thermal camera
- UV filter

Cables

Power and Signal cable
2m, 7m, 15m or 30m

Video Cable (for IR thermal camera)
10m, 20m or 40m

Cables connected from factory



Power supply

100-240VAC

Accessories

Control system



- Number of operator panels
- Ethernet switch
- Integration features
- Control cable Ethernet



Authorized Distributor:
Pacific Marine & Industrial
www.pacificmarine.net
info@pacificmarine.net

Images

